

35 mm x 80 mm x 56 mm NKE 11307 self aligning ball bearings

Bearing No. 11307

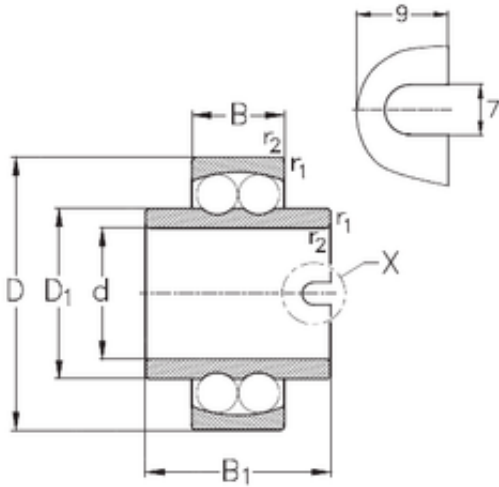

11307 Bearing 2D drawings and 3D CAD models

| | |
|-------------------------------|-------------|
| Size | 35x80x56 mm |
| Bore Diameter | 35 mm |
| Outer Diameter | 80 mm |
| Width | 56 mm |
| d | 35 mm |
| D | 80 mm |
| B | 56 mm |
| C | 21 mm |
| r1 min. | 1,5 mm |
| r2 min. | 1,5 mm |
| D1 | 51,7 mm |
| Weight | 0,85 Kg |
| Basic dynamic load rating (C) | 26,2 kN |
| Basic static load rating (C0) | 8,5 kN |